

CAN SORTERS

MODEL CM-18-10

This medium volume can sorter allows you to easily sort aluminum cans from steel, bi-metal or other ferrous materials. It allows you to sort aluminum cans before you buy them by simply dumping them into the 3/4 cu. yd. hopper. Its 5" casters make it mobile.

STANDARD PRODUCT FEATURES

- Rated capacity of 3000 lbs per hour
- Easily separates aluminum cans from steel and other contaminants
- Factory direct parts and service
- 6" self cleaning tail pulley
- Direct drive speed reducer
- 3/4 cubic yard hopper and constructed of heavy gauge steel
- Discharge chute for ferrous cans

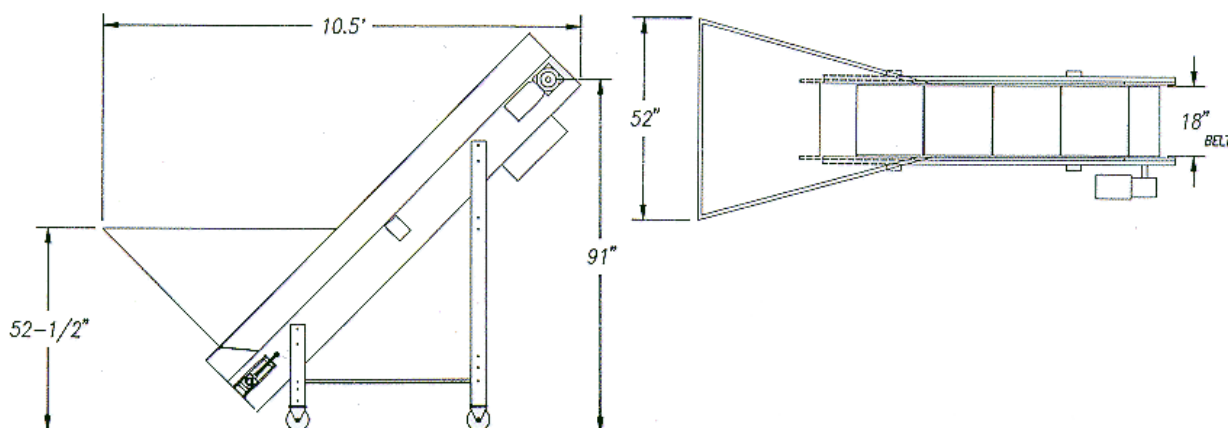

SPECIFICATIONS

1/2 HP Motor	8" permanent magnetic head pulley
Capacity of over 3000 lbs per hour	Dirt and moisture screen in hopper
Conveyor bed 18" wide by 10' long	Thermal rated start/stop button
PVC 120 belting with 2" bonded cleats	5" casters for mobility

Due to continual product improvement Compactors Inc. reserves the right to change specifications without notice. The information and pictures used in the document are for illustrative purposes only. Due to continual product improvement Compactors Inc. reserves the right to change specifications without notice. The information and pictures used in the document are for illustrative purposes only.