

VERTICAL COMPACTORS

VCP Series

The PTR VCP Series is a space saving, affordable, self-contained compaction system for weekly volume of 100 cu. yds. or more of trash. Instead of wind blown containers, the VCP controls housekeeping, deters short dumpers and vermin while reducing pilferage and refuse costs. They can be loaded from the ground, through a wall with a door and chute or off a dock with a door and chute.

The PTR VCP Series has been engineered to provide many years of reliable service. The heavy-duty structural steel components are welded by certified AWS (American Welding Society) technicians and tested to ensure high compaction forces.

The standard unit is U.L. approved and has standard 3 button controls (On/Off key switch, mushroom stop, start button) and a 20' Sealtite power connection.



VCP SERIES SPECIFICATIONS

	VCP-4	VCP-6	VCP-8
Compactor Height	91 7/8" (233 cm)	101" (257 cm)	123 1/4" (313 cm)
Height to Top of Light	97" (246 cm)	106" (269 cm)	128" (325 cm)
Compactor Head Width	101" (257 cm)	101" (257 cm)	101" (257 cm)
Compactor Depth	85 1/2" (217 cm)	85 1/2" (217 cm)	85 1/2" (217 cm)
Overall Compactor Width	96 1/2" (245 cm)	96 1/2" (245 cm)	96 1/2" (245 cm)
Load Height	45 1/4" (115 cm)	58 1/4" (148 cm)	76 1/2" (194 cm)

FEATURES

- **Charge Box Capacity** - .73 cu-yd [.6 cu-m]
- **Feed Opening** (l X w) - 26" X 47" [66 cm x 119 cm]
- **Capacity Per Hour** - 120 cy/hr
- **Average Cycle Time** - 30 sec
- **Total normal Force** – 28,920 lbs [128,643 n]
- **Total Maximum Force** – 33,786 lbs [150,288 n]
- **Normal Ram Pressure** - 15 psi [103 kpa]
- **Maximum Ram Pressure** - 17 psi [117 kpa]
- **Electric** - 208 / 230 / 460 - 3 phase
- **Control Voltage** - 120 vac
- **Motor** - 3 hp
- **Pump** - 3.2 gpm [12.1 l/m]
- **Normal Pressure** - 2,100 psi [13,790 kpa]
- **Maximum Pressure** - 2,400 psi [15,858 kpa]
- **Cylinder Bore** - 4" [10.2 cm]
- **Cylinder Rod** - 2" [5 cm]
- **Cylinder Stroke** – 16" [41 cm]
- **Weight** - 5,000 lbs [2,268 kg]

DESIGNED FOR

- | | |
|--------------------------------|-------------------------|
| - Retail stores | - Rest Area Truck Stops |
| - Quick Serve Restaurants | - Resorts |
| - Gas Stations and Quick Marts | - Hospitals |
| - Supermarkets | - Schools |

*The VCP is a great substitute for
a Self-Contained compactor
when space is limited*

VERTICAL COMPACTORS

VCP Series

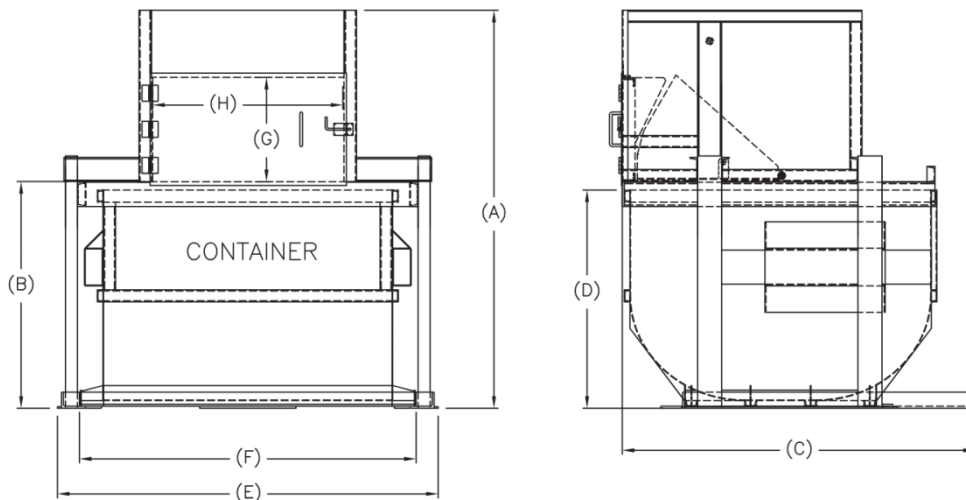

		A	B	C	D	E	F	G	H
Front & Rear Feed	4 YD	86"	43"	88"	41"	95"	84"	26"	47 ½"
	6 YD	100"	57"	88"	54 ½"	95"	84"	26"	47 ½"
	8 YD	118"	75"	88"	72 ½"	95"	84"	26"	47 ½"
Side Feed	4 YD	86"	43"	99"	41"	95"	84"	26"	47 ½"
	6 YD	100"	57"	99"	54 ½"	95"	84"	26"	47 ½"
	8 YD	118"	75"	99"	72 ½"	95"	84"	26"	47 ½"
Rear Load	4 YD	92"	52"	91"	52"	96"	84"	26"	47 ½"

BENEFITS

- Pak-Tite: 4 to 1 compaction ratio
- Self-Contained, liquid-tight can design
- Completely 100% UL approved
- 3-way safe & secure interlock system
- Versatile design will accommodate a 4, 6 or 8 yd. container
- Container stops eliminate can movement
- Front, side or rear load feed design
- Feed door automatically locks
- Oversized feed baffle eliminates trash on the platen

The Vertical ComPactor, or "VCP," is an affordable, self-contained compaction system for situations where space is limited, roll-off collection is unavailable or load versatility is desired

VERTICAL COMPACTOR FEED STYLES

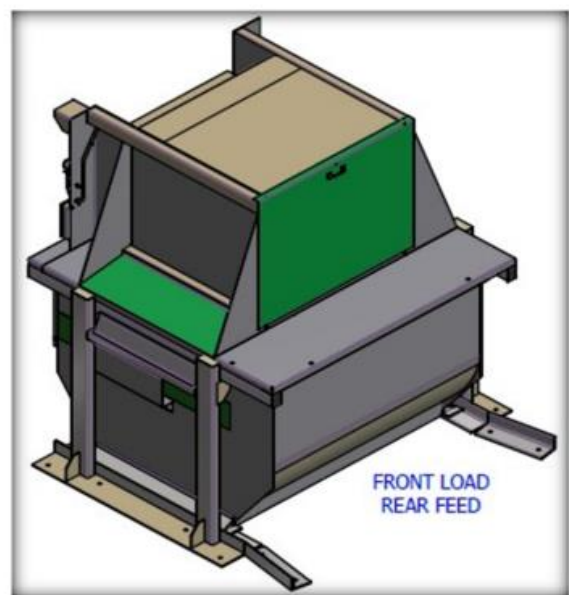
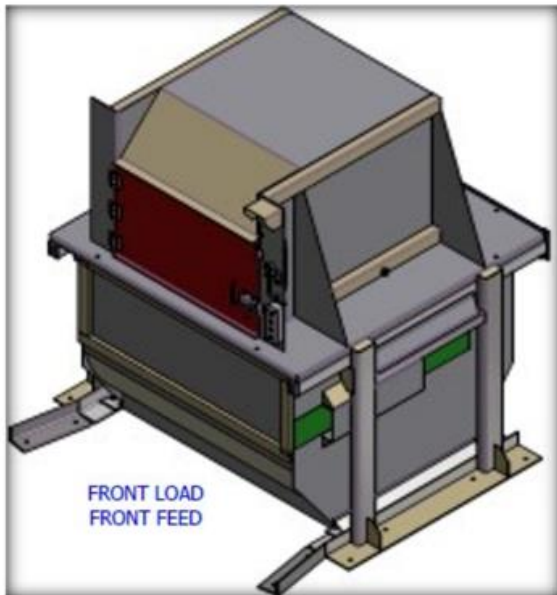
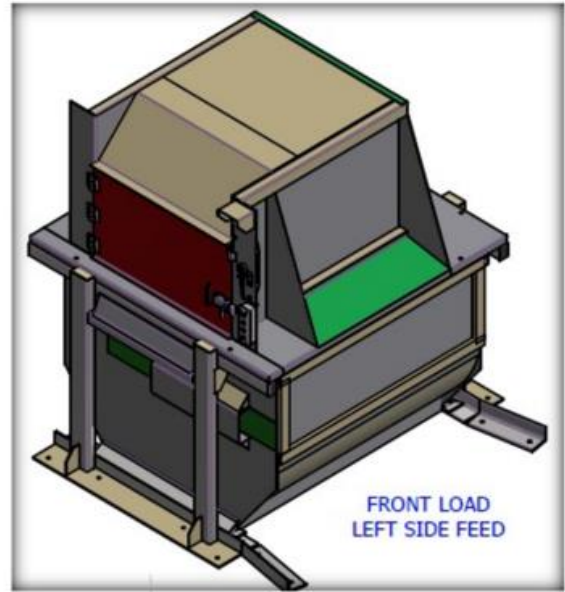
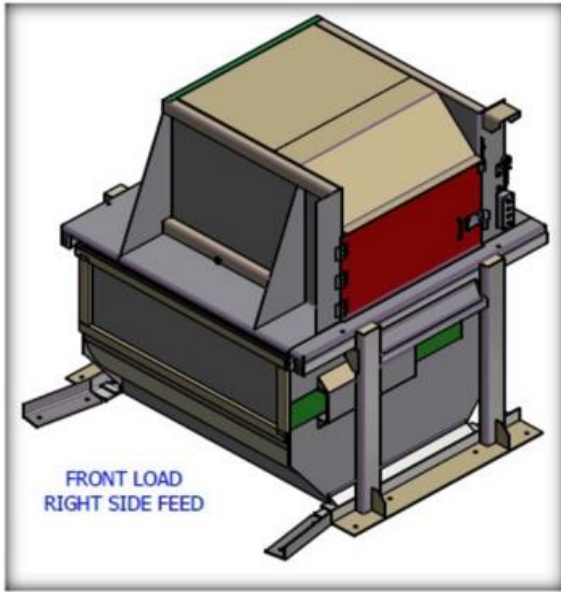

Due to continual product improvement Compactors Inc. reserves the right to change specifications without notice.

The information and pictures used in the document are for illustrative purposes only.